

BUTZ -- Tube clamps



Tube clamps

DIN 3015

Programme:

Tube clamps series A (according to DIN 3015 Part 1)

Available in seven standard sizes for normal mechanical requirements.

- Outer tube diameter for the metric series 6 to 57 mm
- Outer tube diameter for the inch-size series R 1/8" to R 1 1/2"
- Outer tube diameter for the imperial size series 1/4" to 2 1/2"

The clamp body is available in a round/closed version.

Welding plates, rail-supports, cover plates and construction types.

Tube clamps series B (according to DIN 3015 Part 3)

Available as a twin tube clamp in five standard sizes for normal mechanical requirements.

Outer tube diameter 6 to 42 mm.

The clamp body is available in a square/open design.

Welding plates, rail-supports, cover plates and construction types.

Clamp halves with different diameters are only possible when used together.

Tube clamps series C (according to DIN 3015 Part 2)

Specially designed for high mechanical requirements, and available in eight standard sizes.

- Outer tube diameter 6 to 220 mm.

The clamp body is available in a square/closed design.

Welding plates, rail-supports, cover plates and construction types.

Design:

According to DIN 3015:

Both upper and lower clamp-halves are identical.

Webs inside the bore of the clamps provide an impact and vibration deadening effect, and absorb the forces towards the direction of the tube axis.

When using hoses and cables, we recommend the use of clamp halves with a smooth bore.

Clamp material:

Polypropylene	-30°C up to	+ 90° C	colour dark green
Polyamide	-40°C up to	+ 120° C	colour black
Rubber	-50°C up to	+ 120° C	colour black
Aluminium	up to	+ 300° C	

All metal parts available also in stainless steel.

Other materials upon request.

Stainless steel qualities

Stainless steel 1.4401/1.4571 (AISI 316/316 TI), resistant against rust and acid.

Accessories material:

Steel. Screws as well as cover plates of series A and B are galvanized.

Rail-supports are also available with zinc plated surface.

Resistance to stress:

The remarkable features of Tube Clamps are their considerable re-set capability, high tensile strength, as well as their very high output strength and excellent resistance to cold. The choice of design and clamp material depends on the specific demands of the mechanical and thermal requirements.

Order code:

The order code for clamp halves as well as the reference No. for complete tube clamps incorporates the serial indication, material description and interior surface.

Example of description:

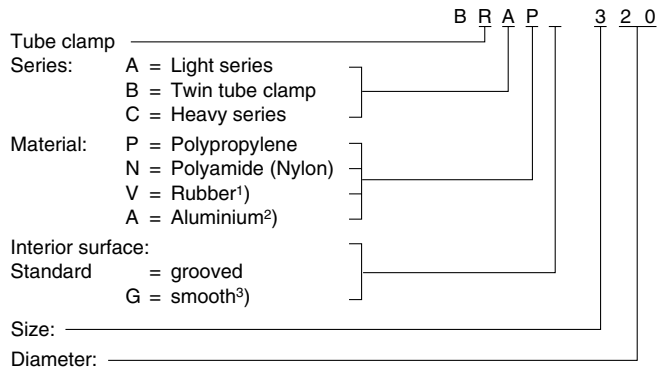

¹⁾ Rubber only available for series A and B, inside smooth and series C grooved design

²⁾ Aluminium only available for series A size 1 to 6 and series C size 1 to 8

³⁾ Smooth interior surface in series C only to size 4
Aluminium clamps only available in a grooved design
Inside smooth series A only size 1 to 6

Registration:

On request

Tube clamps material properties

DIN 3015

Mechanical properties		Polypropylene (PP)	Polyamide 6 (PA 6)	Aluminium	Rubber
Density		0.906 g/cm ³	1.12–1.15g/cm ³	2.65 g/cm ³	0.98 g/cm ³
Flexural deflection	DIN 53452	36 N/mm ²	130...200 N/mm ²	70 N/mm ²	–
Impact resistance	DIN 53453	no break	no break	–	
Compressive strength	DIN 53454	90 N/mm ²	120 N/mm ²	HB 500...600 N/mm ²	A and B: 64° shore C: 73° shore
Modulus of elasticity	DIN 53452	1500 N/mm ²	3000 N/mm ²	70.000 N/mm ²	
Tensile strength					A and B: 6.1 N/mm ²
without breakage	DIN 53454	25–35 N/mm ²	80–90 N/mm ²	180 N/mm ²	C: 8.5 N/mm ²

Thermal properties					
Temp. resistance		–30 ... + 90°C	–40 ... + 120°C	300°C	–50 ... +120°C

Chemical properties					
Weak acids		limited resistant	limited resistant		resistant
Weak alkalis		limited resistant	limited resistant		resistant
Alcohol		resistant	resistant		resistant
Petrol		limited resistant	resistant		limited resistant
Mineral oils		resistant	resistant		resistant
Other oils		resistant	resistant		resistant

The outlined particulars are approximate values and are only shown for reference, which are not binding, and with regard to possible protection of third parties. They do not exempt you from your own examination of suitability of the products delivered by us. Therefore, these values can only be used in a limited way for guidance only.

The application of the products is carried out outside of our control and, therefore, is exclusively subject to your own area of responsibility. Any claim however would be limited for all damages to the value of the goods supplied by us and in use by you.

It goes without saying, that we guarantee the perfect quality of our products according to our general sales and delivery conditions.

Tube clamps assembly instruction

DIN 3015

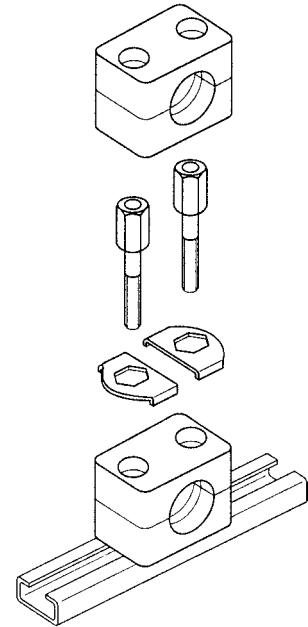
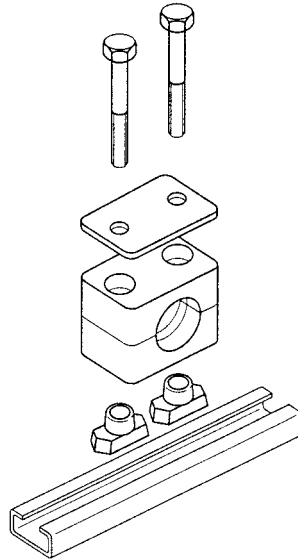
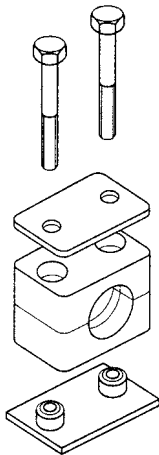

Assembly:

Assembly on to metal welding plates

Place welding plates on a base appropriate for the load. Make sure that the clamps are properly aligned. Clamp lower clamp half onto welding plate, insert tube, place upper clamp half onto lower half and fasten with the screws. Attention must be paid to the bias (after completed assembly, clamp halves may not be in contact)! Do not weld with fitted plastic clamp!
Extended welding plates may be screw-fastened to the base.

Assembly on support rails

Support rails are available in four different heights and come in pieces of 1 m or 2 m length, as required. Weld on support rail or screw-fasten with fastening angle bracket. Insert support rail nuts in rail and turn until stoppage. For heavy duty construction series, nuts are simply pushed in. Clamp lower clamp half on support rail nuts, insert tube, place upper clamp half onto lower half and fasten with the screws. Before fastening the screws the clamp may still be positioned. Attention must be paid to the bias (after completed assembly, the clamp halves may not be in contact)!

Construction assembly

Clamps allow the assembly of multiple clamps of the same construction size and of different tube diameters one above the other. The construction assembly is carried out with special fixing screws that are secured against twisting by applying a locking plate. Clamp lower clamp half on welding plate or support rail respectively, insert tube, place upper clamp half on lower half and fasten with fixing screws. The fixing screw juts out from the upper clamp half. The application of a locking plate securely fastens the fixing screw and prevents twisting. Clamp on second clamp half on to the fixing screws etc.

Tube clamps series A(light construction series)-complete range

- Polypropylene – **BRAP**
- Inside smooth – **BRAPG**
- Polyamide 6 – **BRAN**
- Inside smooth – **BRANG**
- Rubber – **BRAVG***
- Aluminium – **BRAA**

(As required please exchange standard abbreviation RAP in column for "Order code")

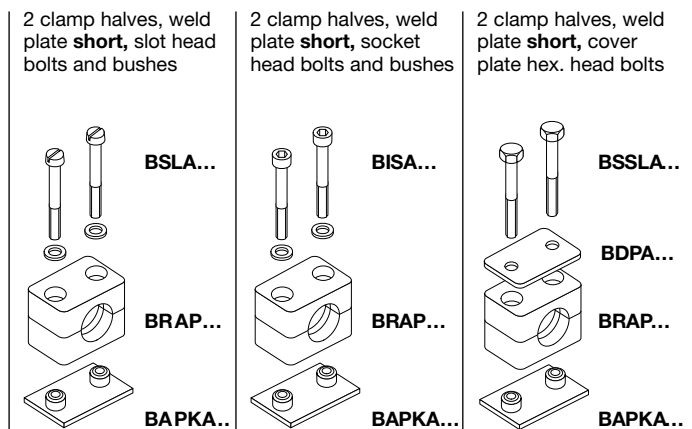

clamp size	Tube O.D. mm	Tube NB	Tube O.D.	Order code	Order code	Order code
0 ¹⁾	6.0	G 1/8	1/4 5/16 3/8	BRAP1-006	BRAP2-006	BRAP3-006
	6.4			BRAP1-006.4	BRAP2-006.4	BRAP3-006.4
	8.0			BRAP1-008	BRAP2-008	BRAP3-008
	9.5			BRAP1-009.5	BRAP2-009.5	BRAP3-009.5
	10.0			BRAP1-010	BRAP2-010	BRAP3-010
	12.0			BRAP1-012	BRAP2-012	BRAP3-012
1	6.0	G 1/8	1/4 5/16 3/8	BRAP1-106	BRAP2-106	BRAP3-106
	6.4			BRAP1-106.4	BRAP2-106.4	BRAP3-106.4
	8.0			BRAP1-108	BRAP2-108	BRAP3-108
	9.5			BRAP1-109.5	BRAP2-109.5	BRAP3-109.5
	10.0			BRAP1-110	BRAP2-110	BRAP3-110
	12.0			BRAP1-112	BRAP2-112	BRAP3-112
2	12.7	G 1/4	1/2	BRAP1-212.7	BRAP2-212.7	BRAP3-212.7
	13.5			BRAP1-213.5	BRAP2-213.5	BRAP3-213.5
	14.0			BRAP1-214	BRAP2-214	BRAP3-214
	15.0	G 3/8	5/8	BRAP1-215	BRAP2-215	BRAP3-215
	16.0			BRAP1-216	BRAP2-216	BRAP3-216
	17.2			BRAP1-217.2	BRAP2-217.2	BRAP3-217.2
18.0	BRAP1-218	BRAP2-218	BRAP3-218			
3	19.0	G 1/2	3/4 1	BRAP1-319	BRAP2-319	BRAP3-319
	20.0			BRAP1-320	BRAP2-320	BRAP3-320
	21.3			BRAP1-321.3	BRAP2-321.3	BRAP3-321.3
	22.0			BRAP1-322	BRAP2-322	BRAP3-322
	23.0			BRAP1-323	BRAP2-323	BRAP3-323
	25.0			BRAP1-325	BRAP2-325	BRAP3-325
4	26.9	G 3/4		BRAP1-426.9	BRAP2-426.9	BRAP3-426.9
	28.0			BRAP1-428	BRAP2-428	BRAP3-428
	30.0			BRAP1-430	BRAP2-430	BRAP3-430
5	32.0	G 1	1 1/4	BRAP1-532	BRAP2-532	BRAP3-532
	33.7			BRAP1-533.7	BRAP2-533.7	BRAP3-533.7
	35.0			BRAP1-535	BRAP2-535	BRAP3-535
	38.0	G 1 1/4	1 1/2	BRAP1-538	BRAP2-538	BRAP3-538
	40.0			BRAP1-540	BRAP2-540	BRAP3-540
	42.0			BRAP1-542	BRAP2-542	BRAP3-542
6	44.5	G 1 1/2	1 3/4	BRAP1-644.5	BRAP2-644.5	BRAP3-644.5
	45.0			BRAP1-645	BRAP2-645	BRAP3-645
	48.0			BRAP1-648	BRAP2-648	BRAP3-648
	50.0			BRAP1-650	BRAP2-650	BRAP3-650
	50.8	2	2	BRAP1-650.8	BRAP2-650.8	BRAP3-650.8
	52.0			BRAP1-652	BRAP2-652	BRAP3-652
	55.0			BRAP1-655	BRAP2-655	BRAP3-655
	57.0			BRAP1-657	BRAP2-657	BRAP3-657

Delivery in unassembled individual components.

¹⁾ Contrary to the illustration size 0 clamps are secured by only one screw.

* Only with cover plate, hexagon screws and locking washers.

Tube clamps series A(light construction series)-complete range

Polypropylene – **BRAP**
 Inside smooth – **BRAPG**
 Polyamide 6 – **BRAN**
 Inside smooth – **BRANG**
 Rubber – **BRAVG***
 Aluminium – **BRAA**

(As required please exchange standard abbreviation RAP in column for "Order code")

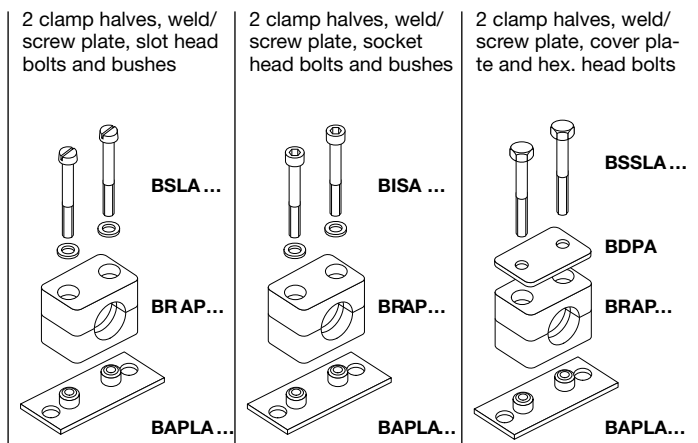

clamp size	Tube O.D. mm	Tube NB	Tube O.D.	Order code	Order code	Order code
0 ¹⁾	6.0	G 1/8	1/4	BRAP4-006	BRAP5-006	BRAP6-006
	6.4			BRAP4-006.4	BRAP5-006.4	BRAP6-006.4
	8.0			BRAP4-008	BRAP5-008	BRAP6-008
	9.5			BRAP4-009.5	BRAP5-009.5	BRAP6-009.5
	10.0			BRAP4-010	BRAP5-010	BRAP6-010
	12.0			BRAP4-012	BRAP5-012	BRAP6-012
1	6.0	G 1/8	1/4	BRAP4-106	BRAP5-106	BRAP6-106
	6.4			BRAP4-106.4	BRAP5-106.4	BRAP6-106.4
	8.0			BRAP4-108	BRAP5-108	BRAP6-108
	9.5			BRAP4-109.5	BRAP5-109.5	BRAP6-109.5
	10.0			BRAP4-110	BRAP5-110	BRAP6-110
	12.0			BRAP4-112	BRAP5-112	BRAP6-112
2	12.7	G 1/4	1/2	BRAP4-212.7	BRAP5-212.7	BRAP6-212.7
	13.5			BRAP4-213.5	BRAP5-213.5	BRAP6-213.5
	14.0			BRAP4-214	BRAP5-214	BRAP6-214
	15.0	G 3/8	5/8	BRAP4-215	BRAP5-215	BRAP6-215
	16.0			BRAP4-216	BRAP5-216	BRAP6-216
	17.2			BRAP4-217.2	BRAP5-217.2	BRAP6-217.2
18.0	BRAP4-218	BRAP5-218	BRAP6-218			
3	19.0	G 1/2	3/4	BRAP4-319	BRAP5-319	BRAP6-319
	20.0			BRAP4-320	BRAP5-320	BRAP6-320
	21.3			BRAP4-321.3	BRAP5-321.3	BRAP6-321.3
	22.0			BRAP4-322	BRAP5-322	BRAP6-322
	23.0			BRAP4-323	BRAP5-323	BRAP6-323
	25.0			BRAP4-325	BRAP5-325	BRAP6-325
4	26.9	G 3/4	1	BRAP4-426.9	BRAP5-426.9	BRAP6-426.9
	28.0			BRAP4-428	BRAP5-428	BRAP6-428
	30.0			BRAP4-430	BRAP5-430	BRAP6-430
5	32.0	G 1	1 1/4	BRAP4-532	BRAP5-532	BRAP6-532
	33.7			BRAP4-533.7	BRAP5-533.7	BRAP6-533.7
	35.0			BRAP4-535	BRAP5-535	BRAP6-535
	38.0	G 1 1/4	1 1/2	BRAP4-538	BRAP5-538	BRAP6-538
	40.0			BRAP4-540	BRAP5-540	BRAP6-540
	42.0			BRAP4-542	BRAP5-542	BRAP6-542
6	44.5	G 1 1/2	1 3/4	BRAP4-644.5	BRAP5-644.5	BRAP6-644.5
	45.0			BRAP4-645	BRAP5-645	BRAP6-645
	48.0			BRAP4-648	BRAP5-648	BRAP6-648
	50.0			BRAP4-650	BRAP5-650	BRAP6-650
	50.8	2	2	BRAP4-650.8	BRAP5-650.8	BRAP6-650.8
	52.0			BRAP4-652	BRAP5-652	BRAP6-652
	55.0			BRAP4-655	BRAP5-655	BRAP6-655
	57.0			BRAP4-657	BRAP5-657	BRAP6-657
	2 1/4					

Delivery in unassembled individual components.

¹⁾ Contrary to the illustration size 0 clamps are secured by only one screw.

* Only with cover plate, hexagon screws and locking washers.

Tube clamps series A(light construction series)-complete range

Polypropylene – **BRAP**
 Inside smooth – **BRAPG**
 Polyamide 6 – **BRAN**
 Inside smooth – **BRANG**
 Rubber – **BRAVG***
 Aluminium – **BRAA**

(As required please exchange standard abbreviation RAP in column for "Order code")

2 clamp halves, rail nuts, slot head bolts and bushes

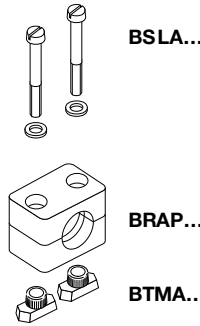

2 clamp halves, rail nuts, socket head bolts and bushes

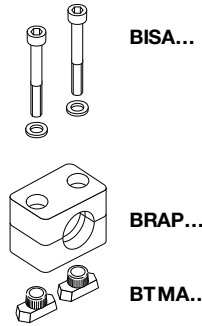

2 clamp halves, rail nuts, cover plate and hex. head bolts

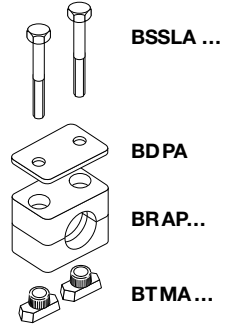

clamp size	Tube O.D. mm	Tube NB	Tube O.D.	Order code	Order code	Order code
0 ¹⁾	6.0	G 1/8	1/4	BRAP9-006	BRAP10-006	BRAP12-006
	6.4			BRAP9-006.4	BRAP10-006.4	BRAP12-006.4
	8.0			BRAP9-008	BRAP10-008	BRAP12-008
	9.5			BRAP9-009.5	BRAP10-009.5	BRAP12-009.5
	10.0			BRAP9-010	BRAP10-010	BRAP12-010
	12.0			BRAP9-012	BRAP10-012	BRAP12-012
1	6.0	G 1/8	1/4	BRAP9-106	BRAP10-106	BRAP12-106
	6.4			BRAP9-106.4	BRAP10-106.4	BRAP12-106.4
	8.0			BRAP9-108	BRAP10-108	BRAP12-108
	9.5			BRAP9-109.5	BRAP10-109.5	BRAP12-109.5
	10.0			BRAP9-110	BRAP10-110	BRAP12-110
	12.0			BRAP9-112	BRAP10-112	BRAP12-112
2	12.7	G 1/4	1/2	BRAP9-212.7	BRAP10-212.7	BRAP12-212.7
	13.5			BRAP9-213.5	BRAP10-213.5	BRAP12-213.5
	14.0			BRAP9-214	BRAP10-214	BRAP12-214
	15.0	G 3/8	5/8	BRAP9-215	BRAP10-215	BRAP12-215
	16.0			BRAP9-216	BRAP10-216	BRAP12-216
	17.2			BRAP9-217.2	BRAP10-217.2	BRAP12-217.2
18.0	BRAP9-218	BRAP10-218	BRAP12-218			
3	19.0	G 1/2	3/4	BRAP9-319	BRAP10-319	BRAP12-319
	20.0			BRAP9-320	BRAP10-320	BRAP12-320
	21.3			BRAP9-321.3	BRAP10-321.3	BRAP12-321.3
	22.0			BRAP9-322	BRAP10-322	BRAP12-322
	23.0			BRAP9-323	BRAP10-323	BRAP12-323
	25.0			BRAP9-325	BRAP10-325	BRAP12-325
4	26.9	G 3/4	1	BRAP9-426.9	BRAP10-426.9	BRAP12-426.9
	28.0			BRAP9-428	BRAP10-428	BRAP12-428
	30.0			BRAP9-430	BRAP10-430	BRAP12-430
5	32.0	G 1	1 1/4	BRAP9-532	BRAP10-532	BRAP12-532
	33.7			BRAP9-533.7	BRAP10-533.7	BRAP12-533.7
	35.0			BRAP9-535	BRAP10-535	BRAP12-535
	38.0	G 1 1/4	1 1/2	BRAP9-538	BRAP10-538	BRAP12-538
	40.0			BRAP9-540	BRAP10-540	BRAP12-540
	42.0			BRAP9-542	BRAP10-542	BRAP12-542
6	44.5	G 1 1/2	1 3/4	BRAP9-644.5	BRAP10-644.5	BRAP12-644.5
	45.0			BRAP9-645	BRAP10-645	BRAP12-645
	48.0			BRAP9-648	BRAP10-648	BRAP12-648
	50.0	2	2	BRAP9-650	BRAP10-650	BRAP12-650
	50.8			BRAP9-650.8	BRAP10-650.8	BRAP12-650.8
	52.0			BRAP9-652	BRAP10-652	BRAP12-652
	55.0			BRAP9-655	BRAP10-655	BRAP12-655
	57.0			BRAP9-657	BRAP10-657	BRAP12-657

Delivery in unassembled individual components.

¹⁾ Contrary to the illustration size 0 clamps are secured by only one screw.

* Only with cover plate, hexagon screws and locking washers.

Tube clamps series A-complete range

Polypropylene – **BRAP**
 Inside smooth – **BRAPG**
 Polyamide 6 – **BRAN**
 Inside smooth – **BRANG**
 Rubber – **BRAVG***
 Aluminium – **BRAA**

(As required please exchange standard abbreviation RAP in column for "Order code")

2 clamp halves, slot heads and bushes

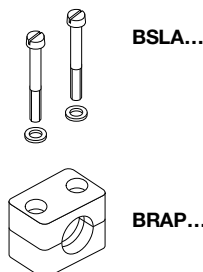

2 clamp halves, socket head bolts and bushes

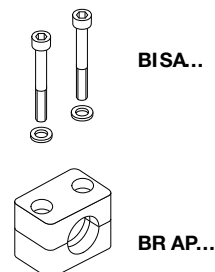

clamp size	Tube O.D. mm	Tube NB	Tube O.D.	Order code	Order code
0 ¹⁾	6.0	G 1/8	1/4	BRAP13-006	BRAP14-006
	6.4			BRAP13-006.4	BRAP14-006.4
	8.0			BRAP13-008	BRAP14-008
	9.5			BRAP13-009.5	BRAP14-009.5
	10.0			BRAP13-010	BRAP14-010
	12.0			BRAP13-012	BRAP14-012
1	6.0	G 1/8	1/4	BRAP13-106	BRAP14-106
	6.4			BRAP13-106.4	BRAP14-106.4
	8.0			BRAP13-108	BRAP14-108
	9.5			BRAP13-109.5	BRAP14-109.5
	10.0			BRAP13-110	BRAP14-110
	12.0			BRAP13-112	BRAP14-112
2	12.7	G 1/4	1/2	BRAP13-212.7	BRAP14-212.7
	13.5			BRAP13-213.5	BRAP14-213.5
	14.0			BRAP13-214	BRAP14-214
	15.0	G 3/8	5/8	BRAP13-215	BRAP14-215
	16.0			BRAP13-216	BRAP14-216
	17.2			BRAP13-217.2	BRAP14-217.2
18.0	BRAP13-218	BRAP14-218			
3	19.0	G 1/2	3/4	BRAP13-319	BRAP14-319
	20.0			BRAP13-320	BRAP14-320
	21.3			BRAP13-321.3	BRAP14-321.3
	22.0		1	BRAP13-322	BRAP14-322
	23.0			BRAP13-323	BRAP14-323
	25.0			BRAP13-325	BRAP14-325
4	26.9	G 3/4		BRAP13-426.9	BRAP14-426.9
	28.0			BRAP13-428	BRAP14-428
	30.0			BRAP13-430	BRAP14-430
5	32.0	G 1	1 1/4	BRAP13-532	BRAP14-532
	33.7			BRAP13-533.7	BRAP14-533.7
	35.0			BRAP13-535	BRAP14-535
	38.0	G 1 1/4	1 1/2	BRAP13-538	BRAP14-538
	40.0			BRAP13-540	BRAP14-540
	42.0			BRAP13-542	BRAP14-542
6	44.5	G 1 1/2	1 3/4	BRAP13-644.5	BRAP14-644.5
	45.0			BRAP13-645	BRAP14-645
	48.0			BRAP13-648	BRAP14-648
	50.0			BRAP13-650	BRAP14-650
	50.8	2	2	BRAP13-650.8	BRAP14-650.8
	52.0			BRAP13-652	BRAP14-652
	55.0			BRAP13-655	BRAP14-655
	57.0			BRAP13-657	BRAP14-657
			2 1/4		

Delivery in unassembled individual components.

¹⁾ Contrary to the illustration size 0 clamps are secured by only one screw.

* Only with cover plate, hexagon screws and locking washers.

Tube clamps series A-complete range

Polypropylene – **BRAP**
 Inside smooth – **BRAPG**
 Polyamide 6 – **BRAN**
 Inside smooth – **BRANG**
 Rubber – **BRAVG***
 Aluminium – **BRAA**

(As required please exchange standard abbreviation RAP in column for "Order code")

2 clamp halves, cover plate and hex. head bolts

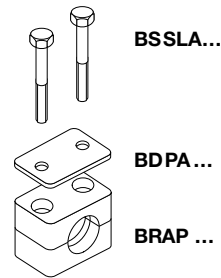

2 clamp halves, stacking bolts and locking plate

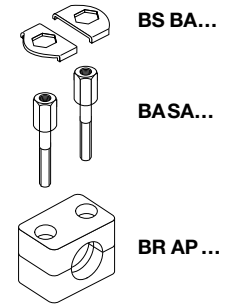

clamp size	Tube O.D. mm	Tube NB	Tube O.D.	Order code	Order code
0 ¹⁾	6.0	G 1/8	1/4	BRAP16-006	BRAP18-006
	6.4			BRAP16-006.4	BRAP18-006.4
	8.0			BRAP16-008	BRAP18-008
	9.5			BRAP16-009.5	BRAP18-009.5
	10.0			BRAP16-010	BRAP18-010
	12.0			BRAP16-012	BRAP18-012
1	6.0	G 1/8	1/4	BRAP16-106	BRAP18-106
	6.4			BRAP16-106.4	BRAP18-106.4
	8.0			BRAP16-108	BRAP18-108
	9.5			BRAP16-109.5	BRAP18-109.5
	10.0			BRAP16-110	BRAP18-110
	12.0			BRAP16-112	BRAP18-112
2	12.7	G 3/8	1/2	BRAP16-212.7	BRAP18-212.7
	13.5			BRAP16-213.5	BRAP18-213.5
	14.0			BRAP16-214	BRAP18-214
	15.0			BRAP16-215	BRAP18-215
	16.0			BRAP16-216	BRAP18-216
	17.2			BRAP16-217.2	BRAP18-217.2
18.0	BRAP16-218	BRAP18-218			
3	19.0	G 1/2	3/4	BRAP16-319	BRAP18-319
	20.0			BRAP16-320	BRAP18-320
	21.3			BRAP16-321.3	BRAP18-321.3
	22.0			BRAP16-322	BRAP18-322
	23.0			BRAP16-323	BRAP18-323
	25.0			BRAP16-325	BRAP18-325
4	26.9	G 3/4	1	BRAP16-426.9	BRAP18-426.9
	28.0			BRAP16-428	BRAP18-428
	30.0			BRAP16-430	BRAP18-430
5	32.0	G 1	1 1/4	BRAP16-532	BRAP18-532
	33.7			BRAP16-533.7	BRAP18-533.7
	35.0			BRAP16-535	BRAP18-535
	38.0	G 1 1/4	1 1/2	BRAP16-538	BRAP18-538
	40.0			BRAP16-540	BRAP18-540
	42.0			BRAP16-542	BRAP18-542
6	44.5	G 1 1/2	1 3/4	BRAP16-644.5	BRAP18-644.5
	45.0			BRAP16-645	BRAP18-645
	48.0			BRAP16-648	BRAP18-648
	50.0			BRAP16-650	BRAP18-650
	50.8	2	2	BRAP16-650.8	BRAP18-650.8
	52.0			BRAP16-652	BRAP18-652
	55.0			BRAP16-655	BRAP18-655
	57.0			BRAP16-657	BRAP18-657
			2 1/4		

Delivery in unassembled individual components.

¹⁾ Contrary to the illustration size 0 clamps are secured by only one screw.

* Only with cover plate, hexagon screws and locking washers.

Tube clamps series B - complete range

Polypropylene – **BRBP**
 Inside smooth – **BRBPG**
 Polyamide 6 – **BRBN**
 Rubber – **BRBVG***

(As required please exchange standard abbreviation RBP in column for "Order code")

2 clamp halves, weld plate, cover plate, hex. head bolt

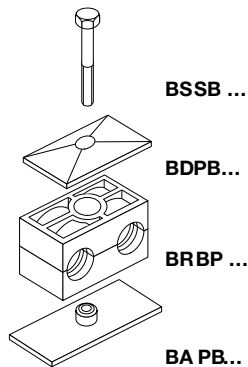

2 clamp halves, weld plate, cover plate, socket head bolt

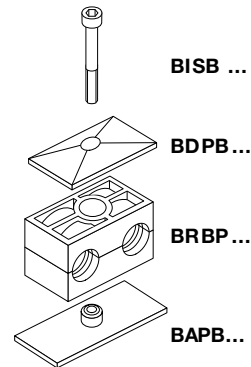

clamp size	Tube O.D. mm	Tube NB	Tube O.D.	Order code	Order code	
1	6.0	G ¹ / ₈	1/4	BRBP1-106	BRBP3-106	
	6.4			BRBP1-106.4	BRBP3-106.4	
	8.0			BRBP1-108	BRBP3-108	
	9.5			BRBP1-109.5	BRBP3-109.5	
	10.0			BRBP1-110	BRBP3-110	
	12.0			BRBP1-112	BRBP3-112	
2	12.7	G ¹ / ₄	1/2	BRBP1-212.7	BRBP3-212.7	
	13.5			BRBP1-213.5	BRBP3-213.5	
	14.0			BRBP1-214	BRBP3-214	
	15.0			BRBP1-215	BRBP3-215	
	16.0	G ³ / ₈	5/8	BRBP1-216	BRBP3-216	
	17.2			BRBP1-217.2	BRBP3-217.2	
	18.0			BRBP1-218	BRBP3-218	
3	19.0	G ¹ / ₂	3/4	BRBP1-319	BRBP3-319	
	20.0			BRBP1-320	BRBP3-320	
	21.3			BRBP1-321.3	BRBP3-321.3	
	22.0			BRBP1-322	BRBP3-322	
	25.0			1	BRBP1-325	BRBP3-325
26.9	BRBP1-426.9	BRBP3-426.9				
4	28.0	G ³ / ₄		BRBP1-428	BRBP3-428	
	30.0			BRBP1-430	BRBP3-430	
	32.0			G1	1 1/4	BRBP1-532
33.7	BRBP1-533.7	BRBP3-533.7				
35.0	BRBP1-535	BRBP3-535				
38.0	G ¹ / ₄	1 1/2	BRBP1-538			BRBP3-538
42.0			BRBP1-542			BRBP3-542

Delivery in unassembled individual components.

*Only with cover plate, hexagon screws and locking washers.

Tube clamps series B - complete range

Polypropylene – **BRBP**
 Inside smooth – **BRBPG**
 Polyamide 6 – **BRBN**
 Rubber – **BRBVG***

(As required please exchange standard abbreviation RBP in column for "Order code")

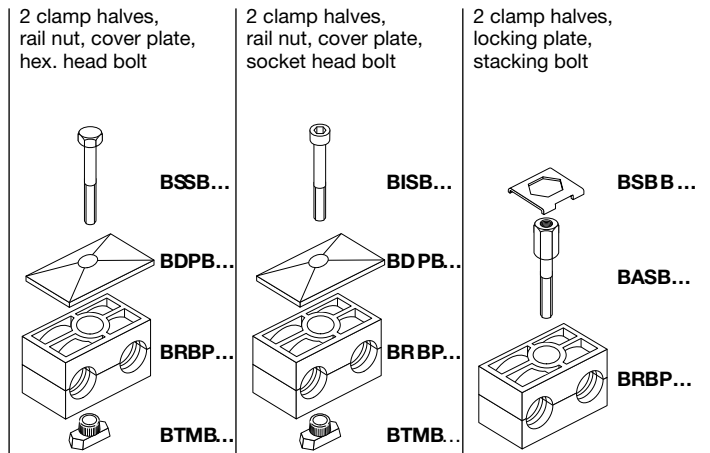

clamp size	Tube O.D. mm	Tube NB	Tube O.D.	Order code	Order code	Order code
1	6.0	G 1/8	1/4	BRBP4-106	BRBP5-106	BRBP8-106
	6.4			BRBP4-106.4	BRBP5-106.4	BRBP8-106.4
	8.0			BRBP4-108	BRBP5-108	BRBP8-108
	9.5			BRBP4-109.5	BRBP5-109.5	BRBP8-109.5
	10.0			BRBP4-110	BRBP5-110	BRBP8-110
	12.0			BRBP4-112	BRBP5-112	BRBP8-112
2	12.7	G 1/4	1/2	BRBP4-212.7	BRBP5-212.7	BRBP8-212.7
	13.5			BRBP4-213.5	BRBP5-213.5	BRBP8-213.5
	14.0			BRBP4-214	BRBP5-214	BRBP8-214
	15.0			BRBP4-215	BRBP5-215	BRBP8-215
	16.0	G 3/8	5/8	BRBP4-216	BRBP5-216	BRBP8-216
	17.2			BRBP4-217.2	BRBP5-217.2	BRBP8-217.2
	18.0			BRBP4-218	BRBP5-218	BRBP8-218
3	19.0	G 1/2	3/4	BRBP4-319	BRBP5-319	BRBP8-319
	20.0			BRBP4-320	BRBP5-320	BRBP8-320
	21.3			BRBP4-321.3	BRBP5-321.3	BRBP8-321.3
	22.0			BRBP4-322	BRBP5-322	BRBP8-322
	25.0			BRBP4-325	BRBP5-325	BRBP8-325
4	26.9	G 3/4	1	BRBP4-426.9	BRBP5-426.9	BRBP8-426.9
	28.0			BRBP4-428	BRBP5-428	BRBP8-428
	30.0			BRBP4-430	BRBP5-430	BRBP8-430
5	32.0	G 1	1 1/4	BRBP4-532	BRBP5-532	BRBP8-532
	33.7			BRBP4-533.7	BRBP5-533.7	BRBP8-533.7
	35.0			BRBP4-535	BRBP5-535	BRBP8-535
	38.0	G 1 1/4	1 1/2	BRBP4-538	BRBP5-538	BRBP8-538
	42.0			BRBP4-542	BRBP5-542	BRBP8-542

Delivery in unassembled individual components.

*Only with cover plate, hexagon screws and locking washers.

Tube clamps series C - complete range

Polypropylene - **BRCP**
 Inside smooth - **BRCPG¹⁾**
 Polyamide 6 - **BRCN**
 Rubber - **BRCVR***
 Aluminium - **BRCA**

(As required please exchange standard abbreviation
 RCP in column for "Order code")

2 clamp halves, weld plate,
cover plate, hex. head bolt

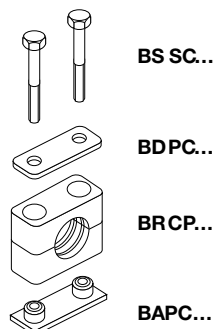

2 clamp halves, weld plate,
cover plate, socket head bolt

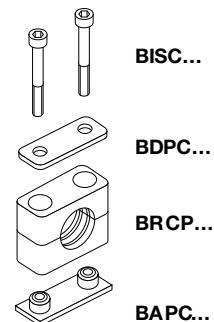

clamp size	Tube O.D. mm	Tube NB	Tube O.D.	Order code	Order code
1	6.0	G 1/8	5/16	BRCP1-106	BRCP2-106
	8.0			BRCP1-108	BRCP2-108
	10.0			BRCP1-110	BRCP2-110
	12.0	G 1/4	1/2	BRCP1-112	BRCP2-112
	12.7			BRCP1-112.7	BRCP2-112.7
	13.5			BRCP1-113.5	BRCP2-113.5
	14.0			BRCP1-114	BRCP2-114
	15.0	G 3/8	5/8	BRCP1-115	BRCP2-115
	16.0			BRCP1-116	BRCP2-116
	17.2			BRCP1-117.2	BRCP2-117.2
18.0	BRCP1-118			BRCP2-118	
2	19.0			G 1/2	3/4
	20.0	BRCP1-220	BRCP2-220		
	21.3	BRCP1-221.3	BRCP2-221.3		
	22.0	BRCP1-222	BRCP2-222		
	23.0	G 3/4	1	BRCP1-223	BRCP2-223
	25.0			BRCP1-225	BRCP2-225
	26.9			BRCP1-226.9	BRCP2-226.9
	28.0			BRCP1-228	BRCP2-228
30.0	BRCP1-230	BRCP2-230			
3	30.0	G 1	1 1/4	BRCP1-330	BRCP2-330
	32.0			BRCP1-332	BRCP2-332
	33.7			BRCP1-333.7	BRCP2-333.7
	35.0			BRCP1-335	BRCP2-335
	38.0	G 1 1/4	1 1/2	BRCP1-338	BRCP2-338
	40.0			BRCP1-340	BRCP2-340
	42.0			BRCP1-342	BRCP2-342
4	38.0	G 1 1/4	1 1/2	BRCP1-438	BRCP2-438
	40.0			BRCP1-440	BRCP2-440
	42.0			BRCP1-442	BRCP2-442
	45.0			BRCP1-445	BRCP2-445
	48.3	G 1 1/2	2	BRCP1-448.3	BRCP2-448.3
	50.0			BRCP1-450	BRCP2-450
	51.0			BRCP1-451	BRCP2-451
	52.0	G 2	2 1/4	BRCP1-452	BRCP2-452
	55.0			BRCP1-455	BRCP2-455
	57.0			BRCP1-457	BRCP2-457
	60.3			BRCP1-460.3	BRCP2-460.3
	63.0			BRCP1-463	BRCP2-463
	65.0			BRCP1-465	BRCP2-465
	70.0			BRCP1-470	BRCP2-470

Continuation see next page ...

Tube clamps series C - complete range

Polypropylene – **BRCP**
 Inside smooth – **BRCPG¹⁾**
 Polyamide 6 – **BRCN**
 Rubber – **BRCVR***
 Aluminium – **BRCA**

(As required please exchange standard abbreviation
 RCP in column for “Order code”)

2 clamp halves, weld plate,
 cover plate, hex. head bolt

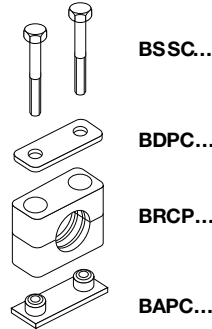

2 clamp halves, weld plate,
 cover plate, socket head bolt

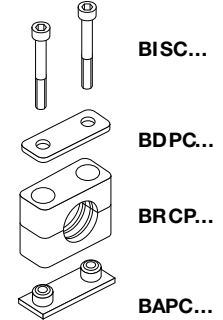

clamp size	Tube O.D. mm	Tube NB	Tube O.D.	Order code	Order code
5	70.0	G 2½	3	BRCP1-570	BRCP2-570
	73.0			BRCP1-573	BRCP2-573
	75.0			BRCP1-575	BRCP2-575
	76.1			BRCP1-576.1	BRCP2-576.1
	80.0	G 3	3¼	BRCP1-580	BRCP2-580
	82.5			BRCP1-582.5	BRCP2-582.5
	88.9			BRCP1-588.9	BRCP2-588.9
90.0			BRCP1-590	BRCP2-590	
6	90.0	G 3½	4	BRCP1-690	BRCP2-690
	97.0			BRCP1-697	BRCP2-697
	100.0			BRCP1-6100	BRCP2-6100
	101.6	G 4	4¼	BRCP1-6101.6	BRCP2-6101.6
	108.0			BRCP1-6108	BRCP2-6108
	114.3			BRCP1-6114.3	BRCP2-6114.3
127.0		5	BRCP1-6127	BRCP2-6127	
7	127.0	G 5	5	BRCP1-7127	BRCP2-7127
	133.0			BRCP1-7133	BRCP2-7133
	140.0			BRCP1-7140	BRCP2-7140
	150.0	G 5½	5½	BRCP1-7150	BRCP2-7150
	152.4			BRCP1-7152.4	BRCP2-7152.4
	159.0			BRCP1-7159	BRCP2-7159
	165.1	G 6	6¼	BRCP1-7165.1	BRCP2-7165.1
168.3	BRCP1-7168.3			BRCP2-7168.3	
8	168.3	G 8	6⅝	BRCP1-8168.3	BRCP2-8168.3
	177.8		7	BRCP1-8177.8	BRCP2-8177.8
	193.7		7⅝	BRCP1-8193.7	BRCP2-8193.7
	203.0			BRCP1-8203	BRCP2-8203
	219.1		8⅝	BRCP1-8219.1	BRCP2-8219.1
	220.0			BRCP1-8220	BRCP2-8220

Delivery in unassembled individual components.

¹⁾ Only sizes 1–4

* Only with cover plate, hexagon screws and locking washers (only sizes 1–4).

Tube clamps series C - complete range

Polypropylene – **BRCP**
 Inside smooth – **BRCPG¹**
 Polyamide 6 – **BRCN**
 Rubber – **BRCVR***
 Aluminium – **BRCA**

(As required please exchange standard abbreviation
 RCP in column for "Order code")

2 clamp halves,
rail nuts, cover plate,
hex. head bolts

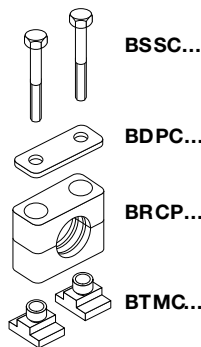

2 clamp halves,
rail nuts, cover plate,
socket head bolts

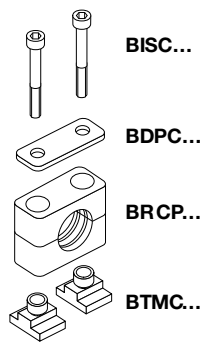

2 clamp halves,
locking plate, stacking
bolts

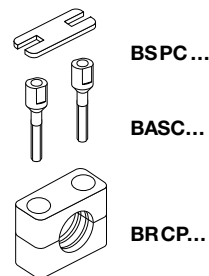

clamp size	Tube O.D. mm	Tube NB	Tube O.D.	Order code	Order code	Order code
1	6.0	G 1/8	5/16	BRCP3-106	BRCP4-106	BRCP5-106
	8.0			BRCP3-108	BRCP4-108	BRCP5-108
	10.0			BRCP3-110	BRCP4-110	BRCP5-110
	12.0	G 1/4	1/2	BRCP3-112	BRCP4-112	BRCP5-112
	12.7			BRCP3-112.7	BRCP4-112.7	BRCP5-112.7
	13.5			BRCP3-113.5	BRCP4-113.5	BRCP5-113.5
	14.0			BRCP3-114	BRCP4-114	BRCP5-114
	15.0	G 3/8	5/8	BRCP3-115	BRCP4-115	BRCP5-115
	16.0			BRCP3-116	BRCP4-116	BRCP5-116
	17.2			BRCP3-117.2	BRCP4-117.2	BRCP5-117.2
18.0	BRCP3-118			BRCP4-118	BRCP5-118	
2	19.0	G 1/2	3/4	BRCP3-219	BRCP4-219	BBRCP5-219
	20.0			BRCP3-220	BRCP4-220	BRCP5-220
	21.3			BRCP3-221.3	BRCP4-221.3	BRCP5-221.3
	22.0			BRCP3-222	BRCP4-222	BRCP5-222
	23.0	G 3/4	1	BRCP3-223	BRCP4-223	BRCP5-223
	25.0			BRCP3-225	BRCP4-225	BRCP5-225
	26.9			BRCP3-226.9	BRCP4-226.9	BRCP5-226.9
	28.0			BRCP3-228	BRCP4-228	BRCP5-228
30.0	BRCP3-230	BRCP4-230	BRCP5-230			
3	30.0	G 1	1 1/4	BRCP3-330	BRCP4-330	BRCP5-330
	32.0			BRCP3-332	BRCP4-332	BRCP5-332
	33.7			BRCP3-333.7	BRCP4-333.7	BRCP5-333.7
	35.0	G 1 1/4	1 1/2	BRCP3-335	BRCP4-335	BRCP5-335
	38.0			BRCP3-338	BRCP4-338	BRCP5-338
	40.0			BRCP3-340	BRCP4-340	BRCP5-340
42.0	BRCP3-342	BRCP4-342	BRCP5-342			
4	38.0	G 1 1/4	1 1/2	BRCP3-438	BRCP4-438	BRCP5-438
	40.0			BRCP3-440	BRCP4-440	BRCP5-440
	42.0			BRCP3-442	BRCP4-442	BRCP5-442
	45.0	G 1 1/2	2	BRCP3-445	BRCP4-445	BRCP5-445
	48.3			BRCP3-448.3	BRCP4-448.3	BRCP5-448.3
	50.0			BRCP3-450	BRCP4-450	BRCP5-450
	51.0			BRCP3-451	BRCP4-451	BRCP5-451
	52.0	G 2	2 1/4	BRCP3-452	BRCP4-452	BRCP5-452
	55.0			BRCP3-455	BRCP4-455	BRCP5-455
	57.0			BRCP3-457	BRCP4-457	BRCP5-457
	60.3			BRCP3-460.3	BRCP4-460.3	BRCP5-460.3
	63.0	2 1/2	2 1/2	BRCP3-463	BRCP4-463	BRCP5-463
	65.0			BRCP3-465	BRCP4-465	BRCP5-465
70.0	BRCP3-470			BRCP4-470	BRCP5-470	

Continuation see next page ...

Tube clamps series C - complete range

Polypropylene – **BRCP**
 Inside smooth – **BRCPG¹⁾**
 Polyamide 6 – **BRCN**
 Rubber – **BRCVR***
 Aluminium – **BRCA**

(As required please exchange standard abbreviation RCP in column for “Order code”)

2 clamp halves, locking plate, stacking bolts

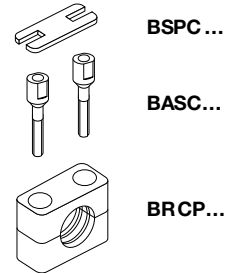

clamp size	Tube O.D. mm	Tube NB	Tube O.D.	Order code
5	70.0	G 2½	3	BRCP5-570
	73.0			BRCP5-573
	75.0			BRCP5-575
	76.1			BRCP5-576.1
	80.0	G 3	3¼	BRCP5-580
	82.5			BRCP5-582.5
	88.9			BRCP5-588.9
90.0			BRCP5-590	
6	90.0	G 3½	4	BRCP5-690
	97.0			BRCP5-697
	100.0			BRCP5-6100
	101.6	G 4	4¼	BRCP5-6101.6
	108.0			BRCP5-6108
	114.3			BRCP5-6114.3
127.0		5	BRCP5-6127	
7	127.0	G 5	5	BRCP5-7127
	133.0			BRCP5-7133
	140.0			BRCP5-7140
	150.0	G 5½	5½	BRCP5-7150
	152.4			BRCP5-7152.4
	159.0	G 6	6	BRCP5-7159
	165.1			BRCP5-7165.1
	168.3			BRCP5-7168.3
8	168.3	G 8	6⅝	BRCP5-8168.3
	177.8		7	BRCP5-8177.8
	193.7		7⅝	BRCP5-8193.7
	203.0			BRCP5-8203
	219.1		8⅝	BRCP5-8219.1
	220.0			

Delivery in unassembled individual components.

¹⁾ Only sizes 1–4

* Only with cover plate, hexagon screws and locking washers (only sizes 1–4).

Tube clamps series C - complete range

Polypropylene – **BRCPD**
 Inside smooth – **BRCPDG¹**
 Polyamide 6 – **BRCND**
 Rubber – **BRCVDR***
 Aluminium – **BRCAD**

(As required please exchange standard abbreviation
 BRCP in column for "Order code")

4 clamp halves, double weld plate,
double cover plate, hex. head bolts

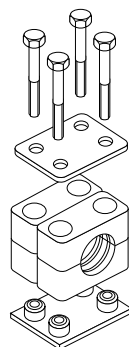

BSSC...

BDPDC...

BRCPD...
(=2XRCP...)

BAPDC...

4 clamp halves, double weld
plate, double cover plate, socket
head bolts

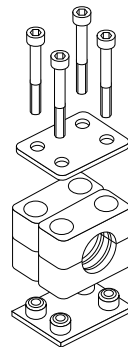

BISC...

BDPDC...

BRCPD...
(=2XRCP...)

BAPDC...

clamp size	Tube O.D. mm	Tube NB	Tube O.D.	Order code	Order code	
1	6.0	G 1/8	5/16	BRCPD1-106	BRCPD2-106	
	8.0			BRCPD1-108	BRCPD2-108	
	10.0			BRCPD1-110	BRCPD2-110	
	12.0	G 1/4	1/2	BRCPD1-112	BRCPD2-112	
	12.7			BRCPD1-112.7	BRCPD2-112.7	
	13.5			BRCPD1-113.5	BRCPD2-113.5	
	14.0			BRCPD1-114	BRCPD2-114	
	15.0	G 3/8	5/8	BRCPD1-115	BRCPD2-115	
	16.0			BRCPD1-116	BRCPD2-116	
	17.2			BRCPD1-117.2	BRCPD2-117.2	
18.0	BRCPD1-118			BRCPD2-118		
19.0	BRCPD1-119			BRCPD2-119		
2	20.0	G 1/2	3/4	BRCPD1-220	BRCPD2-220	
	21.3			BRCPD1-221.3	BRCPD2-221.3	
	22.0			BRCPD1-222	BRCPD2-222	
	23.0			BRCPD1-223	BRCPD2-223	
	25.0	G 3/4	1	BRCPD1-225	BRCPD2-225	
	26.9			BRCPD1-226.9	BRCPD2-226.9	
	28.0			BRCPD1-228	BRCPD2-228	
	30.0			BRCPD1-230	BRCPD2-230	
	30.0			BRCPD1-330	BRCPD2-330	
	32.0			BRCPD1-332	BRCPD2-332	
3	33.7	G 1	1 1/4	BRCPD1-333.7	BRCPD2-333.7	
	35.0			BRCPD1-335	BRCPD2-335	
	38.0			BRCPD1-338	BRCPD2-338	
	40.0	G 1 1/4	1 1/2	BRCPD1-340	BRCPD2-340	
	42.0			BRCPD1-342	BRCPD2-342	
	38.0			G 1 1/4	1 1/2	BRCPD1-438
40.0	BRCPD1-440	BRCPD2-440				
42.0	BRCPD1-442	BRCPD2-442				
45.0	BRCPD1-445	BRCPD2-445				
48.3	G 1 1/2	2	BRCPD1-448.3			BRCPD2-448.3
50.0			BRCPD1-450			BRCPD2-450
51.0	G 2	2 1/4	BRCPD1-451			BRCPD2-451
52.0			BRCPD1-452			BRCPD2-452
55.0			BRCPD1-455			BRCPD2-455
57.0			BRCPD1-457			BRCPD2-457
60.3			2 1/2	2 1/2	BRCPD1-460.3	BRCPD2-460.3
63.0	BRCPD1-463	BRCPD2-463				
65.0	BRCPD1-465	BRCPD2-465				
70.0			BRCPD1-470	BRCPD2-470		

Continuation see next page ...

Tube clamps series C - complete range

Polypropylene- **BRCPD**
 Inside smooth - **BRCPDG** ¹⁾
 Polyamide 6 - **BRCND**
 Rubber - **BRCVDR***
 Aluminium - **BRCAD**

(As required please exchange standard abbreviation RCP in column for "Order code")

4 clamp halves, double weld plate, double cover plate, hex. head bolts

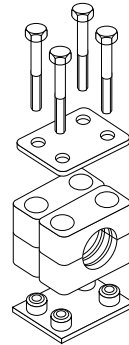

BSSC...

BDPDC...

**BRCPD...
(=2XRCP...)**

BAPDC...

4 clamp halves, double weld plate, double cover plate, socket head bolts

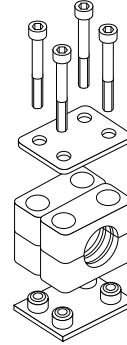

BISC...

BDPDC...

**BRCPD...
(=2XRCP...)**

BAPDC...

clamp size	Tube O.D. mm	Tube NB	Tube O.D.	Order code	Order code
5	70.0	G 2½	3	BRCPD1-570	BRCPD2-570
	73.0			BRCPD1-573	BRCPD2-573
	75.0			BRCPD1-575	BRCPD2-575
	76.1			BRCPD1-576.1	BRCPD2-576.1
	80.0	G 3	3¼	BRCPD1-580	BRCPD2-580
	82.5			BRCPD1-582.5	BRCPD2-582.5
	88.9			BRCPD1-588.9	BRCPD2-588.9
	90.0			BRCPD1-590	BRCPD2-590
6	90.0	G 3½	4	BRCPD1-690	BRCPD2-690
	97.0			BRCPD1-697	BRCPD2-697
	100.0			BRCPD1-6100	BRCPD2-6100
	101.6			BRCPD1-6101.6	BRCPD2-6101.6
	108.0	G 4	4¼	BRCPD1-6108	BRCPD2-6108
	114.3			BRCPD1-6114.3	BRCPD2-6114.3
	127.0			BRCPD1-6127	BRCPD2-6127
7	127.0	G 5	5	BRCPD1-7127	BRCPD2-7127
	133.0			BRCPD1-7133	BRCPD2-7133
	140.0			BRCPD1-7140	BRCPD2-7140
	150.0	G 5½	5½	BRCPD1-7150	BRCPD2-7150
	152.4			BRCPD1-7152.4	BRCPD2-7152.4
	159.0			BRCPD1-7159	BRCPD2-7159
	165.1	G 6	6¼	BRCPD1-7165.1	BRCPD2-7165.1
	168.3			BRCPD1-7168.3	BRCPD2-7168.3
8	168.3	G 8	6⅝	BRCPD1-8168.3	BRCPD2-8168.3
	177.8		7	BRCPD1-8177.8	BRCPD2-8177.8
	193.7		7⅝	BRCPD1-8193.7	BRCPD2-8193.7
	203.0		BRCPD1-8203	BRCPD2-8203	
	219.1		8⅝	BRCPD1-8219.1	BRCPD2-8219.1
	220.0		BRCPD1-8220	BRCPD2-8220	

Delivery in unassembled individual components.

¹⁾ Only sizes 1-4

* Only with cover plate, hexagon screws and locking washers (only sizes 1-4).

Tube clamps series C with absorbing noise insert

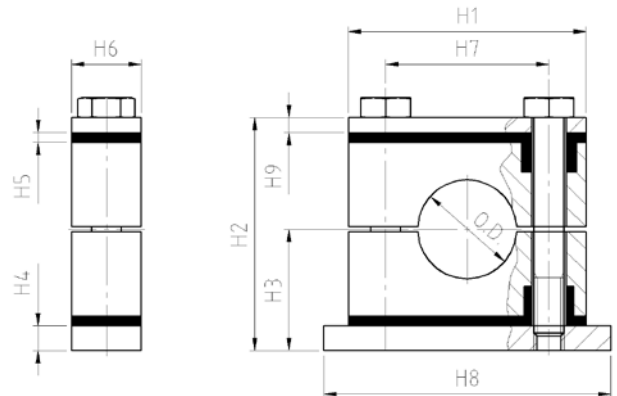

Clamp size	Tube O.D.mm	Absorbing plate	Weld plate	Bolt ISO 4014	H1	H2	H3	H4	H5	H6	H7	H8	H9
1	6.0	BDPEC1X	BAPCD1X	M10X65	55	69	38	15	7	30	33	70	8
	8.0												
	9.5												
	10.0												
	12.0												
	12.7												
	13.5												
	14.0												
	15.0												
	16.0												
17.2													
18.0													
2	19.0	BDPEC2X	BAPCD2X	M10X80	70	85	46	15	7	30	45	85	8
	20.0												
	21.3												
	22.0												
	23.0												
	25.0												
	26.9												
	28.0												
30.0													
3	30.0	BDPEC3X	BAPCD3X	M10X90	85	97	52	15	7	30	60	100	8
	32.0												
	33.7												
	35.0												
	38.0												
	40.0												
42.0													
4	38.0	BDPEC4X	BAPCD4X	M12X130	115	134	72	20	7	45	90	140	10
	40.0												
	42.0												
	45.0												
	48.3												
	50.0												
	51.0												
	52.0												
	54.0												
	55.0												
	57.0												
	60.3												
	63.5												
	65.0												
70.0													